



2-PC. SCREWED END BALL VALVE

2006S

FEATURES



- Full port, 1/4"~3" (DN8~DN80)
- W.P. : 1000 WOG (PN63)
- W.T. : -20°C~200°C (-4°F~392°F)
- Investment casting
- Blow-out proof stem
- Locking device
- Tapped & drilled mounting pad (option)
- TA-Luft approved (option)
- Length conform to DIN 3202/4-M3-2006SM3 (option)
- Thread type : ASME B1.20.1 (NPT)
DIN2999 & BS21
ISO7/1 & EN10226

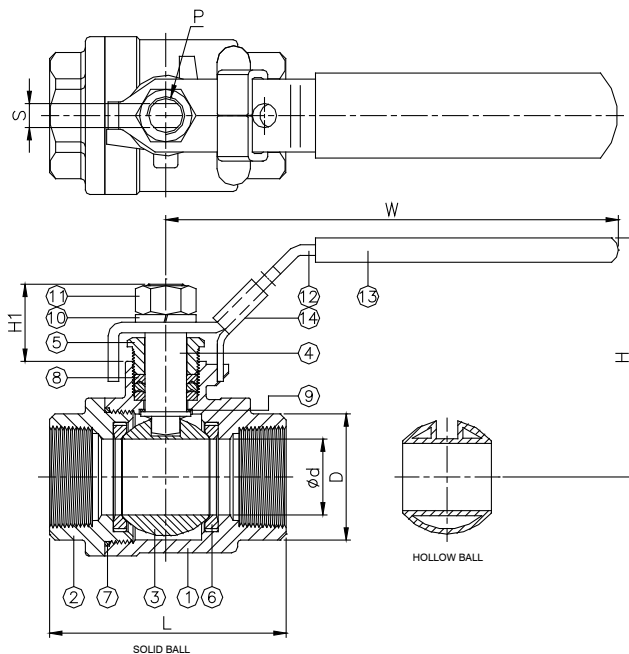

ITEM	PARTS	MATERIAL	
1	BODY	ASTM A351-CF8M	ASTM A216-WCB
2	CAP		
3	SOLID BALL	ASTM A351-CF8M	
	HOLLOW BALL	ASTM A240-316	
4	STEM	ASTM A276-316	
5	GLAND	AISI 304	
6	SEAT	PTFE / RTFE	
7	SEAL		
8	PACKING	PTFE	
9	THRUST WASHER		
10	SPRING WASHER		
11	NUT	AISI 304	
12	HANDLE	STAINLESS STEEL	
13	HANDLE SLEEVE	PVC	
14	LOCKING DEVICE	STAINLESS STEEL	

DN	d	D	L	H	H1	W	S	P	Torque (N·M)	Weight (kg)	
										SOLID BALL	HOLLOW BALL
8	11.6	19	50.8	58.5	18.5	99.5	5	3/8"-24UNF	3.5	0.2	-
10	12.5	22.5	50.8	58.5	18.5	99.5	5	3/8"-24UNF	4	0.2	-
15	15	26	58	60.5	18.8	99.5	5	3/8"-24UNF	5.5	0.3	-
20	20	32	65.6	63	23.4	123	6.5	7/16"-20UNF	7.5	0.5	-
25	25	38	78.7	79.5	26.15	149	8	7/16"-20UNF	11	0.8	-
32	32	48	90	86	23.6	149	8	7/16"-20UNF	15	1.1	-
40	38	54.8	105	101.7	28.2	190	10	1/2"-20UNF	20	1.8	-
50	50	67	124	109.3	23.4	190	10	1/2"-20UNF	40	2.7	2.3
65	63	85	146	140	39.4	247	12	3/4"-10UNF	60	5.6	4.5
80	76	100	163.2	148.5	39.4	247	12	3/4"-10UNF	85	7.5	6.2

unit:mm

NPS	d	D	L	H	H1	W	S	P	Torque (in·lb)	Weight (lb)	
										SOLID BALL	HOLLOW BALL
1/4"	0.46	0.75	2	2.3	0.73	3.92	0.2	3/8"-24UNF	31	0.5	-
3/8"	0.49	0.89	2	2.3	0.73	3.92	0.2	3/8"-24UNF	35.4	0.5	-
1/2"	0.59	1.02	2.28	2.38	0.74	3.92	0.2	3/8"-24UNF	48.7	0.7	-
3/4"	0.79	1.26	2.58	2.48	0.92	4.84	0.26	7/16"-20UNF	66.4	1	-
1"	0.98	1.5	3.1	3.13	1.03	5.87	0.31	7/16"-20UNF	97.4	1.7	-
1-1/4"	1.26	1.89	3.54	3.39	0.93	5.87	0.31	7/16"-20UNF	132.8	2.5	-
1-1/2"	1.5	2.16	4.13	4	1.11	7.48	0.39	1/2"-20UNF	177	3.9	-
2"	1.97	2.64	4.88	4.3	0.92	7.48	0.39	1/2"-20UNF	354	5.9	5.1
2-1/2"	2.48	3.35	5.75	5.51	1.55	9.72	0.47	3/4"-10UNF	531	12.4	9.9
3"	2.99	3.94	6.43	5.85	1.55	9.72	0.47	3/4"-10UNF	752.3	16.5	13.7

unit:in